

TUNNEL LOADING MACHINE

ITC 315 - SL



image not contractual, may contain optional equipment.

- For heading in soft ground and high speed mucking of blasted rock
- Minimal cross-section approx. 20 m²
- Thermal drive 180 kW
- Electric drive 132 kW
- Operating weight 43 t



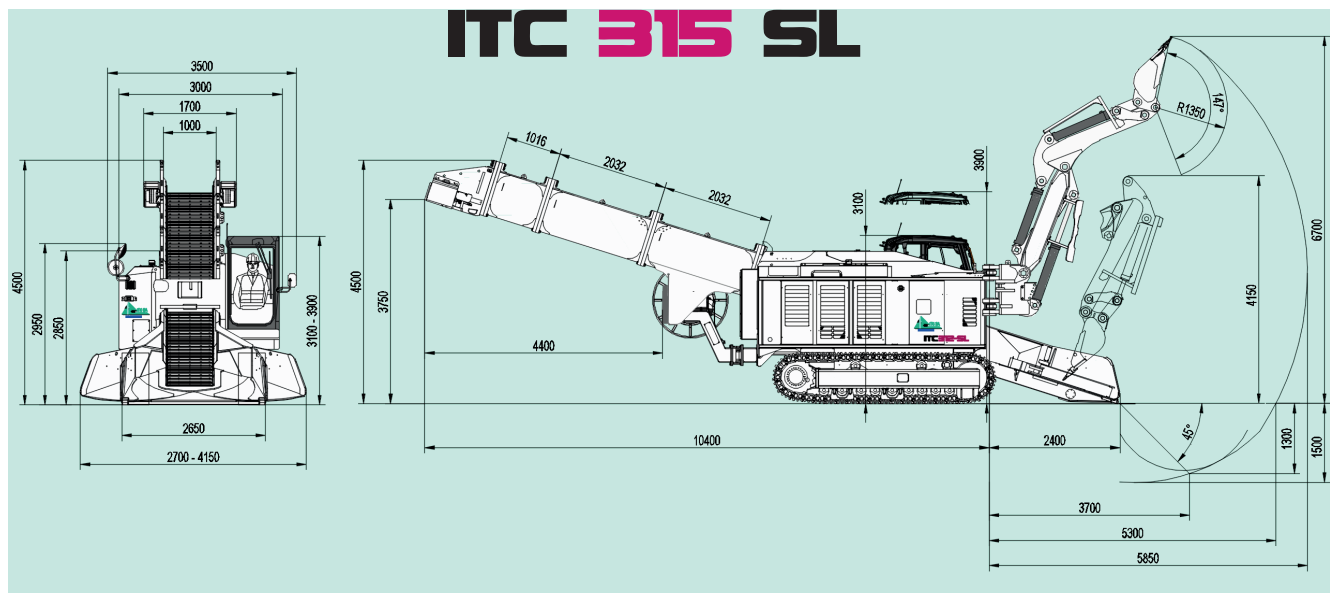

Technical data ITC 315 - SL

Drive units

Electro-hydraulic and Diesel hydraulic power packs each with a separate pump unit with variable flow rate
 Electric drive for emission-free work at the face
 Air-cooled electric motor, power at 400 Volt , 50 Hz 132 kW
 Diesel drive for travelling and operation without electric supply.
 Water-cooled diesel engine, Deutz TCD 6.1
 Diesel engine complies with emission standard: EU V ready, US T4f, Option : ROW
 Power rating at 2'300 r.p.m 180 kW
 Fuel tank 420 l

Electrical system (other tension and frequency upon request)

Total installed power 140 kW
 Voltage (standard) 400 V - 50 Hz AC
 Pilot voltage 220 V CA
 Control voltage thermic drive 24 V CC
 Electrical system acc. to EN 60529 (IP54)
 Cable reel hydraulically driven with abt 75 m cable capacity

Operator's stand

Comfortable Volvo closed cab gives all-round visibility, FOPS canopy and front protection grid.
 Air conditioning.
 CE conformity incl. video monitoring system for the right and rear side with color LCD in the cab.

Hydraulic system

Load Sense hydraulic system with combination of a double axial piston pump and gear pump
 Hydr. pilot control for travelling and main working functions
 Boom control with 2 joysticks in Euro standards
 Thermostatic controlled hydr. driven oil/air cooler
 Max. hydraulic operating pressure 250-350 bar
 Hydraulic oil tank capacity 400 l
 Pump delivery Diesel engine 520 l/min
 Pump delivery Electric motor 540 l/min
 Hydraulic oil capacity (incl. tank) 500 l

Operating data

Machine width 2'750 mm
 Maximal height 3'650 mm
 Transport height 3'350 mm
 Transport length with folded equipment ~13'000 mm

Conveyor system

Width of loading apron (adjust.) 2'700 - 4'100 mm
 Width of conveyor (internal) 1000 mm
 Height of conveyor (internal) 800 mm
 Conveyor capacity approx. 600 m³/h
 Conveyor discharge height 2'500-3'500 mm

Boom SL

- Minimal cross section approx. 20 m²
- Boom equipment for loading of soft ground or blasted material, includes:
 - King post with jib and dipper stick
 - Excavation and mucking bucket, width 400-1200 mm
 - Hydraulic circuit for a hydraulic rock breaker
 - Loading capacity acc. to rock conditions approx. 5-12 m³/min
 - Operating weight approx. 43 t

Options (different possibilities on order)

Elevator cabin, conveyor extension elements, rubber plate conveyor, automatic grease central, automatic fire extinguisher system, quick couplers, other loading and / or excavation tools, water spraying system for dust reduction with hose reel, etc.

Other details, executions (ATEX) and accessories on request.
 Subject to change without notice.



ITC SA

www.itcsa.com info@itcsa.com ☎+41 277 222 191

Tunnel Heading and Loading Machine
Model ITC 315 SL H1
Front, side and top view with boom geometry

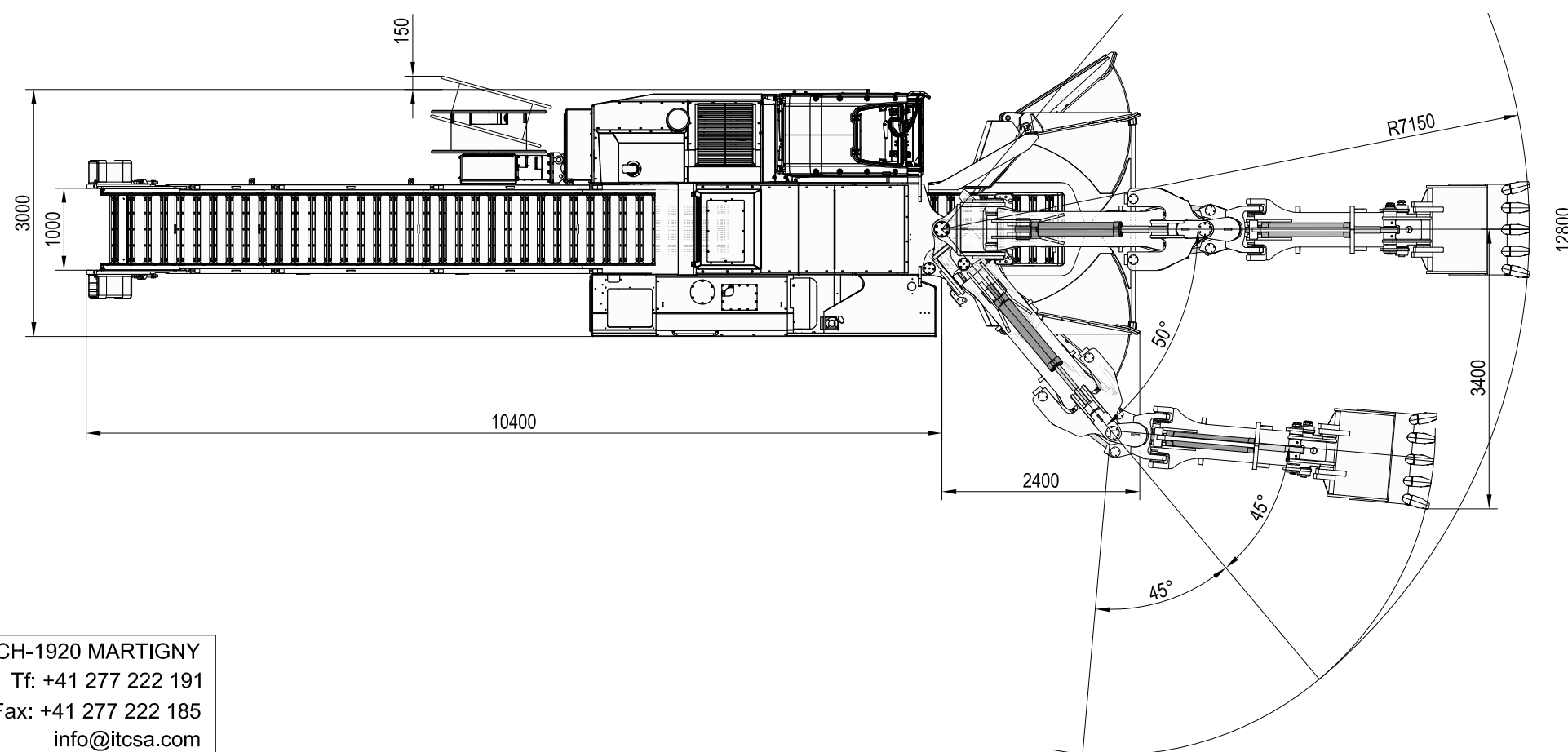
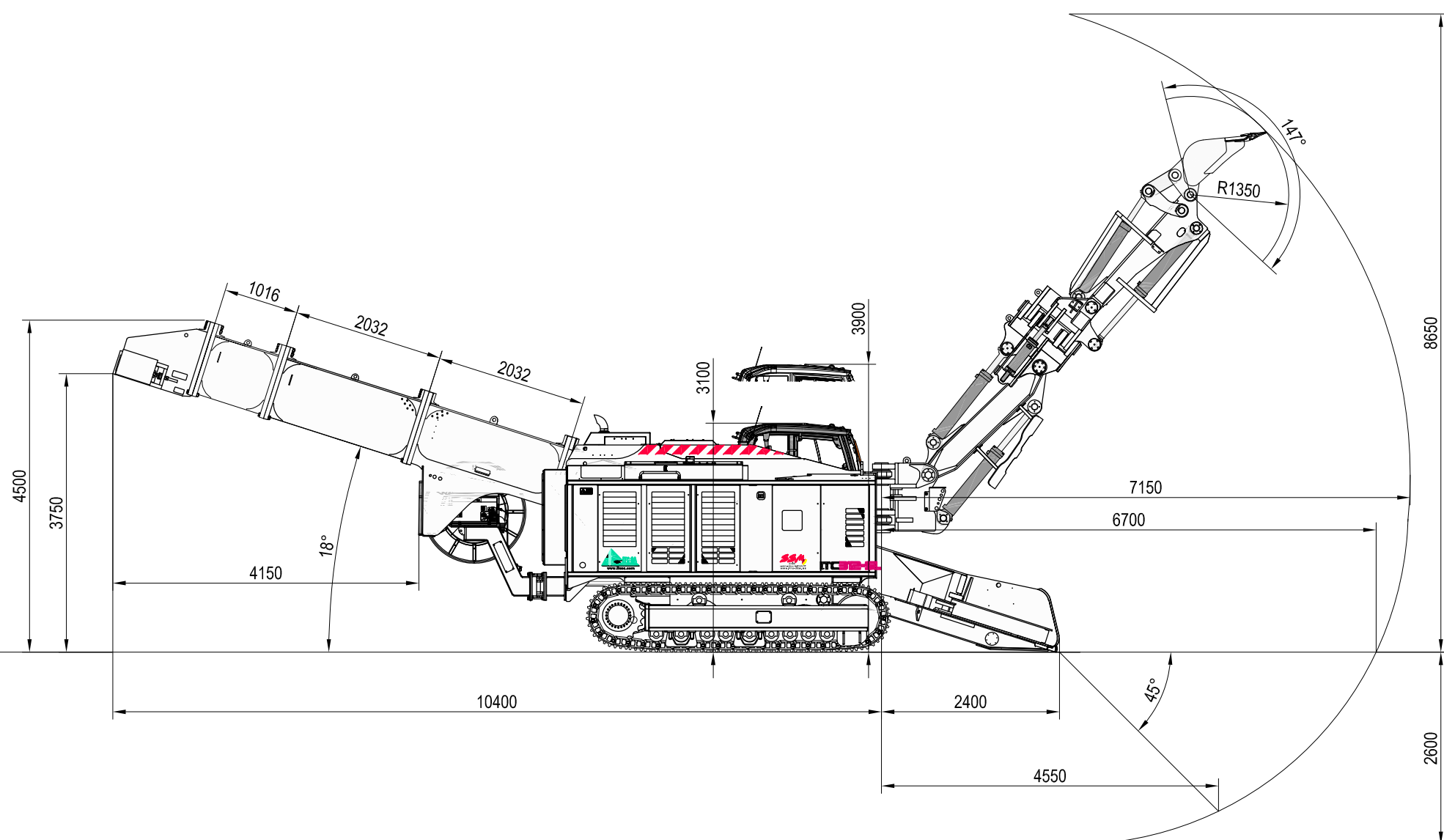
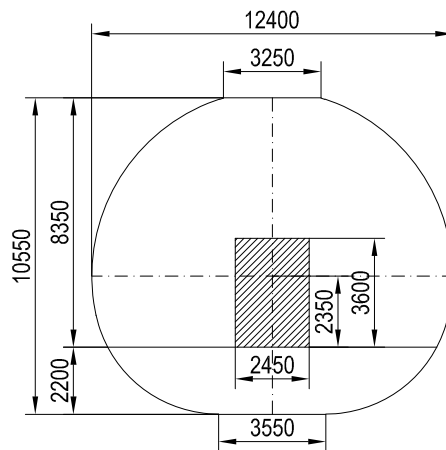
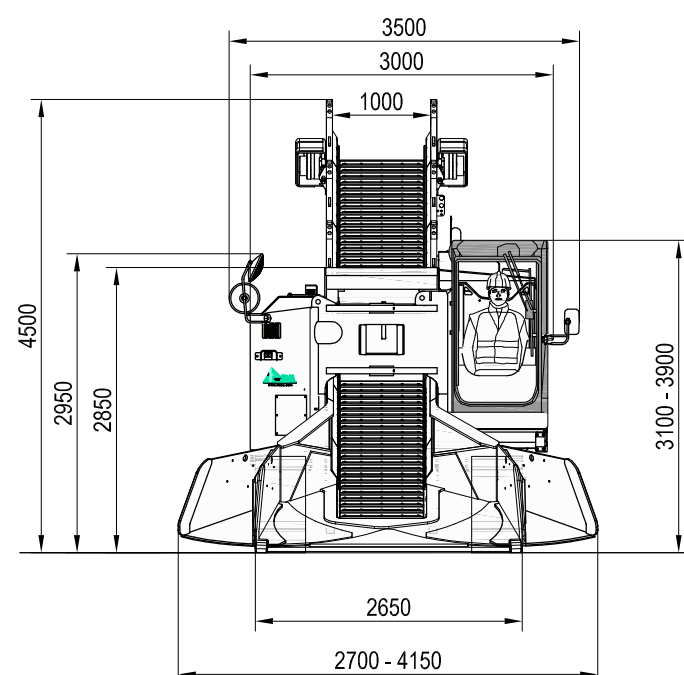

Force acc. to ISO 6015, with standard bucket

Breakaway torque	139 kN
Tear-out force over console	68 kN
Tear-out force over dipper stick	73 kN
Lifting power (without working tool)	10 kN
Specific ground pressure	13,4 N/cm²
Global weight	35,9 t



S810

24.09.2019 PB
I:\Acad\dessin_S\S810\
Dessin non contractuel
Rev.N°: Date:

A3 - 1:75



CH-1920 MARTIGNY
Tf: +41 277 222 191
Fax: +41 277 222 185
info@itcsa.com

Tunnel Loading Machine
Model ITC 315N H3
3 views with loading position and boom geometry

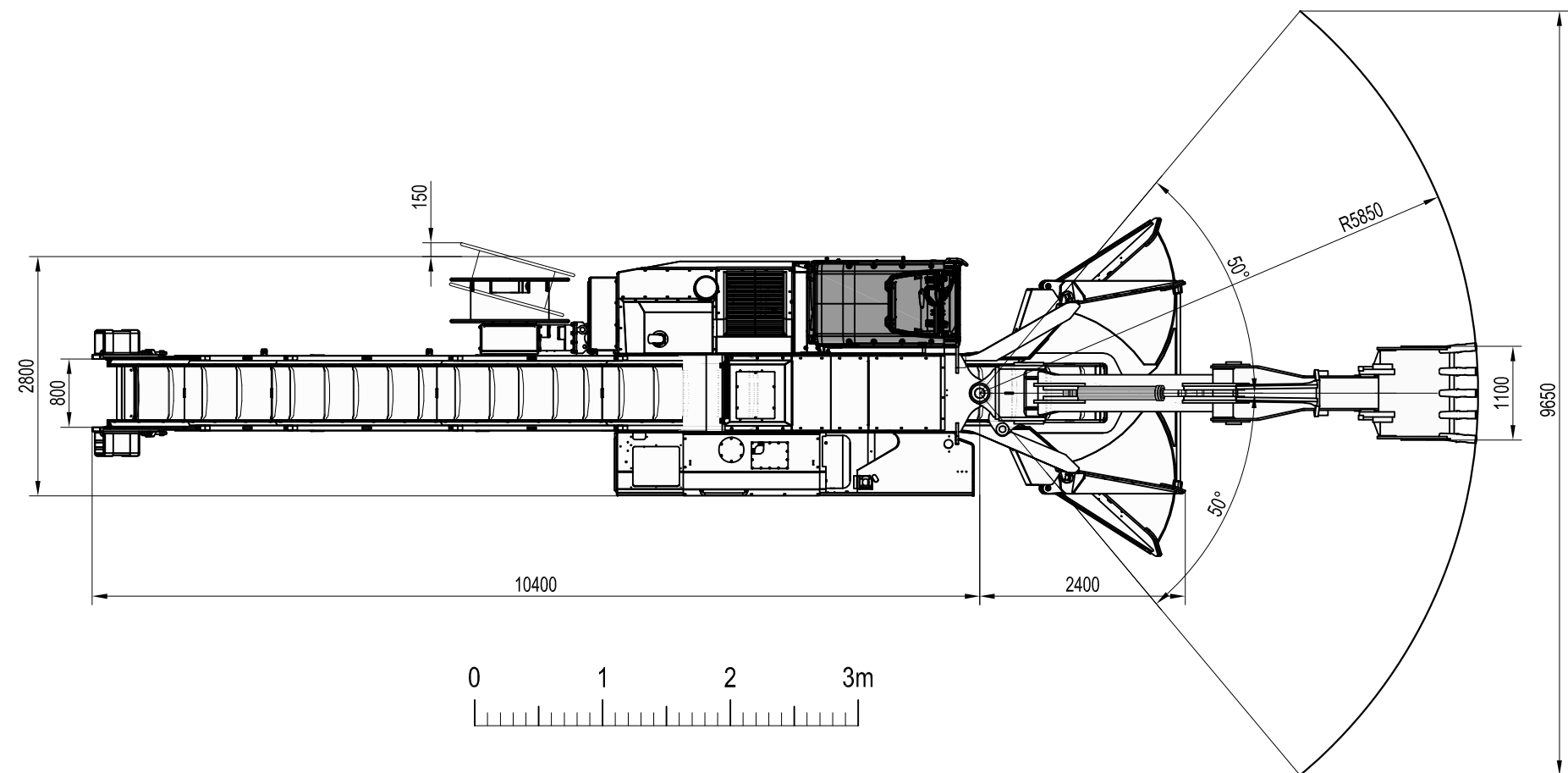
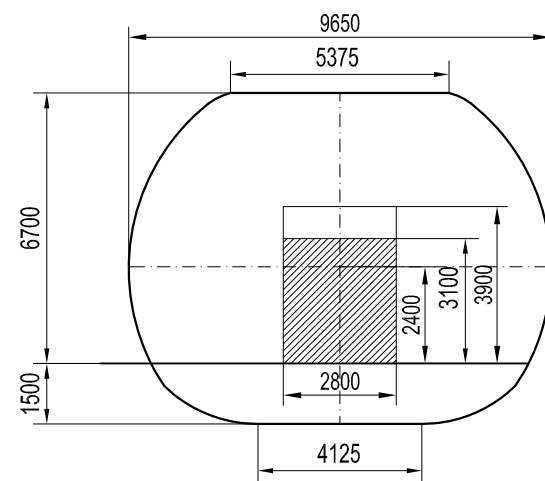
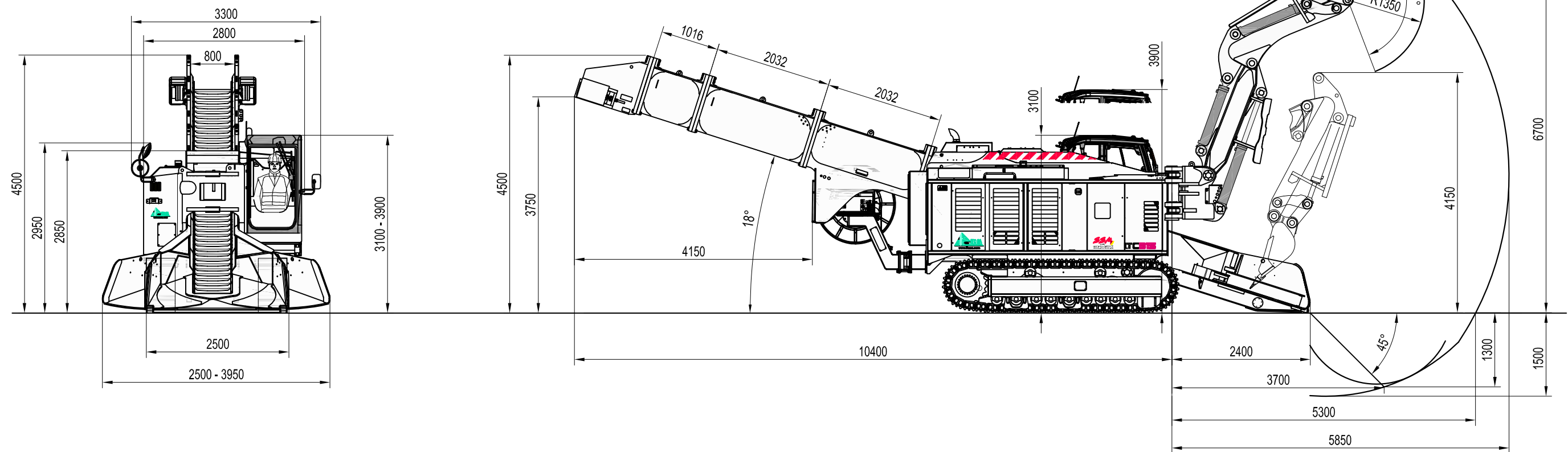

Force acc. to ISO 6015, with standard bucket

Breakaway torque	119 kN
Tear-out force over dipper stick	96 kN
Lifting power (without working tool)	20 kN
Specific ground pressure	10 N/cm ²
Global weight	35 t

S910

16.04.2020 PB
I:\Acad\dessin_S\ITC315N\
Dessin non contractuel
Rev.N°: Date:

A3 - 1:75



CH-1920 MARTIGNY
Tf: +41 277 222 191
Fax: +41 277 222 185
info@itcsa.com

Tunnel Loading Machine
Model ITC 315N H3L
3 views with loading position and boom geometry

Force acc. to ISO 6015, with standard bucket	
Breakaway torque	119 kN
Tear-out force over dipper stick	96 kN
Lifting power (without working tool)	20 kN
Specific ground pressure	10 N/cm²
Global weight	35 t

Tunnel Loading Machine
Model ITC 315N H3s
3 views with loading position and boom geometry

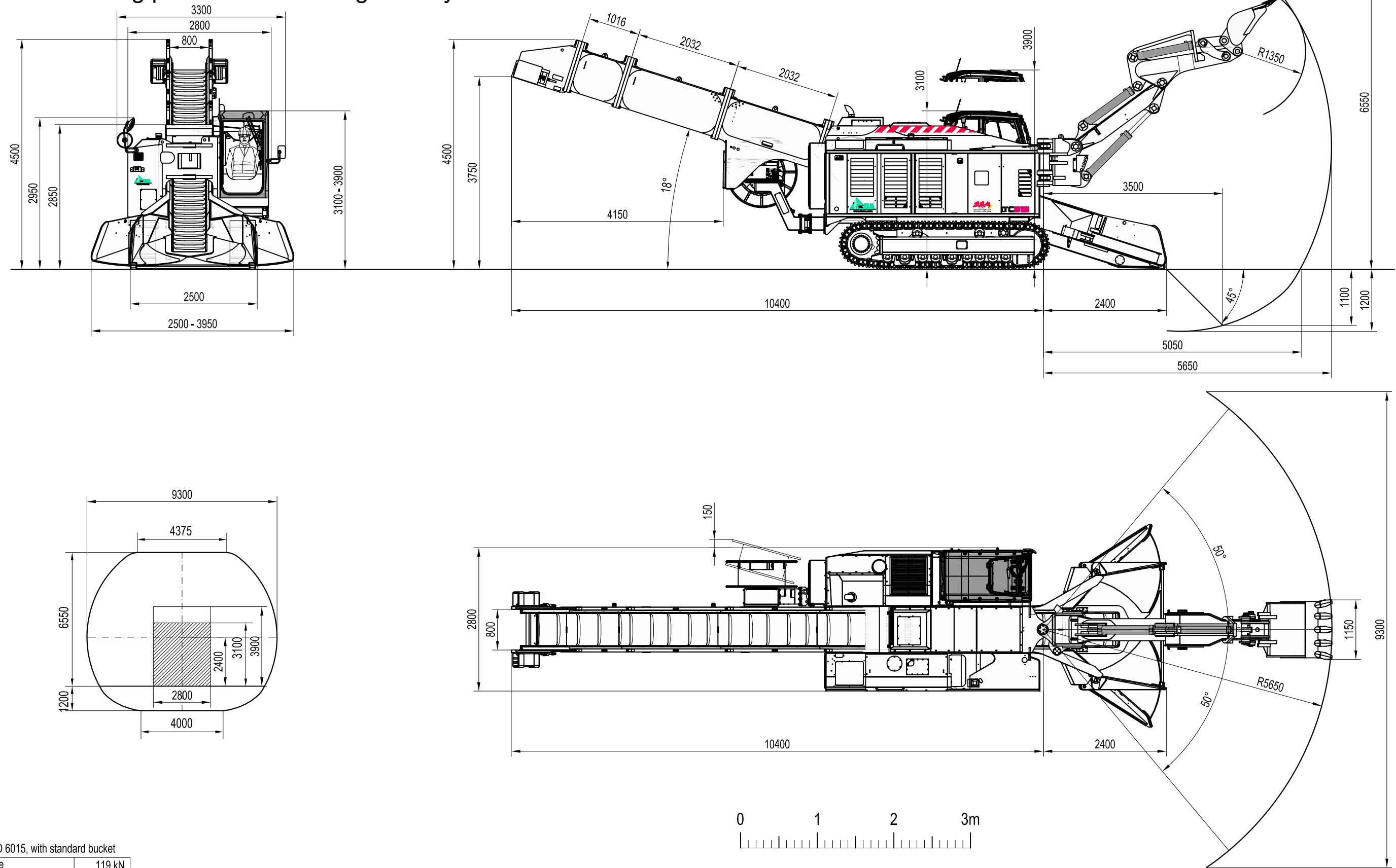

Force acc. to ISO 6015, with standard bucket

Breakaway torque	119 kN
Tear-out force over dipper stick	96 kN
Lifting power (without working tool)	20 kN
Specific ground pressure	10 N/cm²
Global weight	35 t

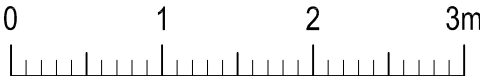

Tunnel Heading and Loading Machine
Model ITC 315N H6
3 views with loading position and boom geometry

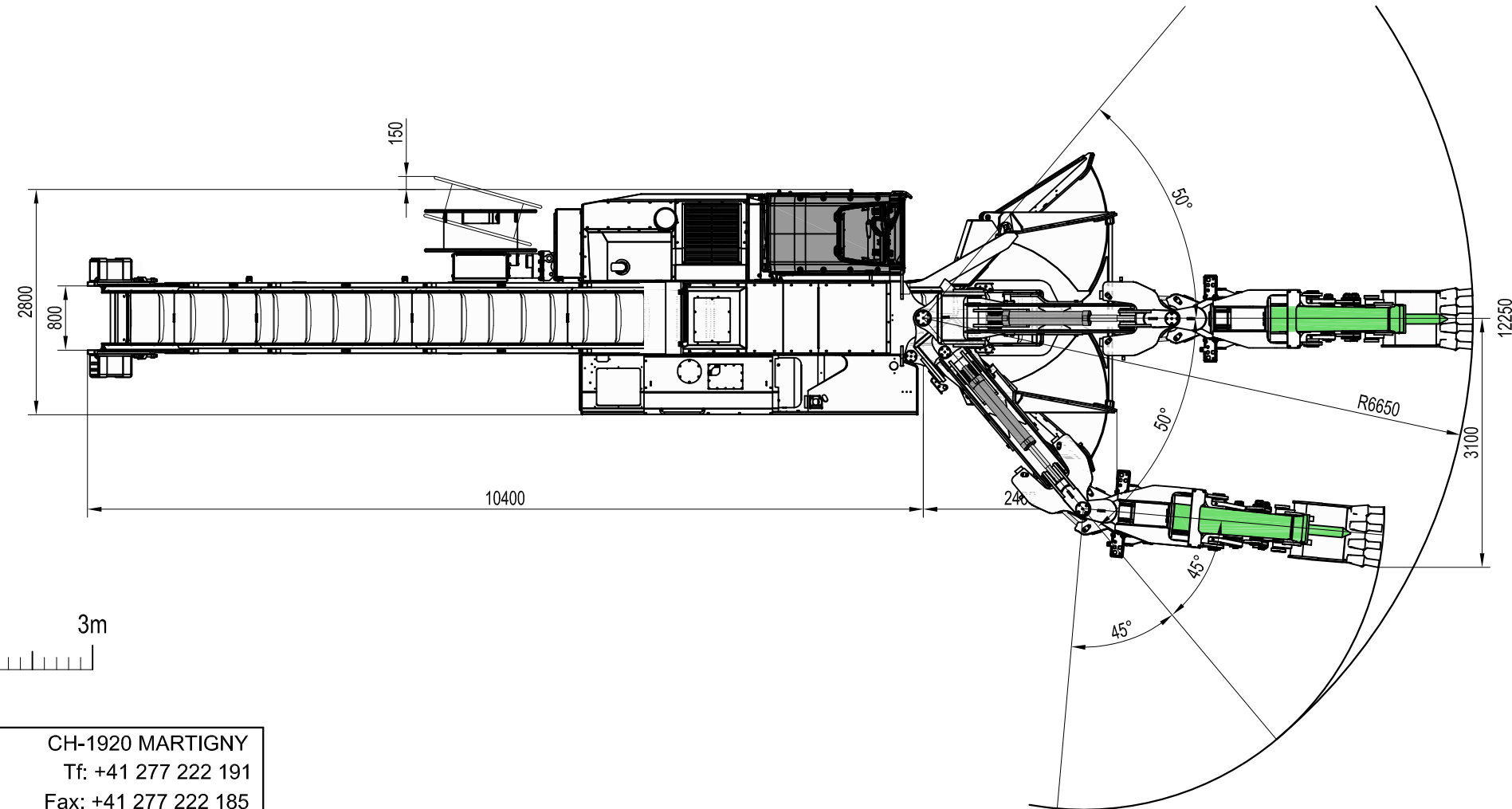
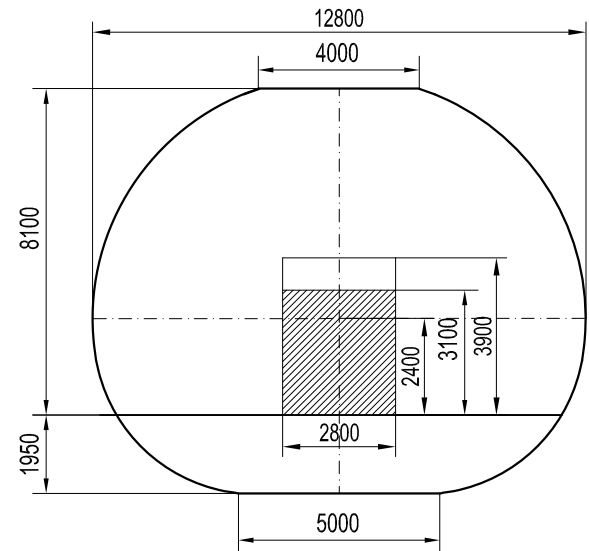
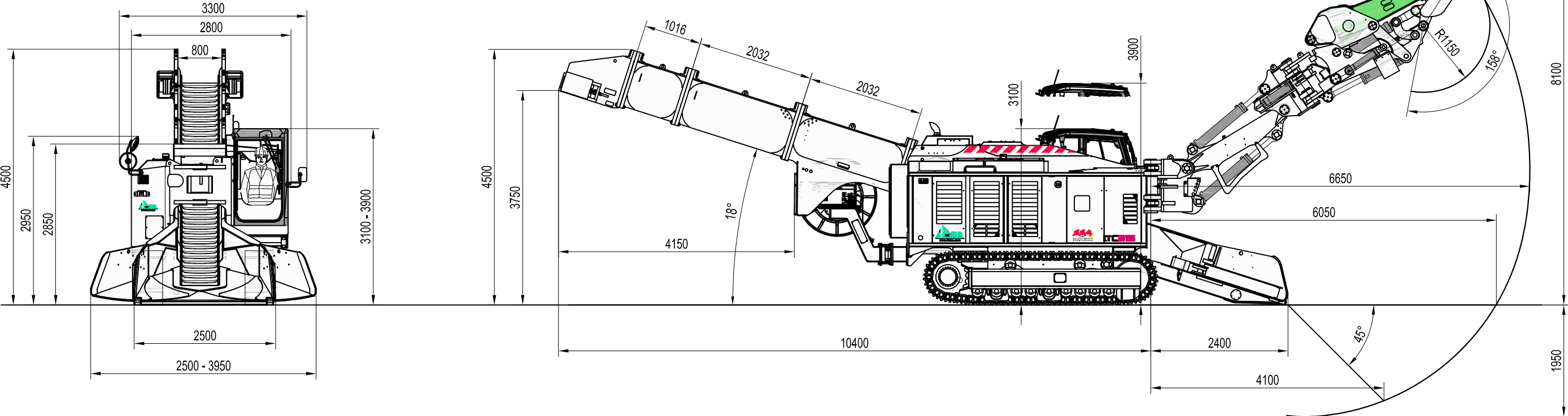

Force acc. to ISO 6015, with standard bucket

Breakaway torque	85 kN
Tear-out force over console	53 kN
Tear-out force over dipper stick	62 kN
Lifting power (without working tool)	5 kN
Specific ground pressure	10 N/cm²
Global weight	36,2 t

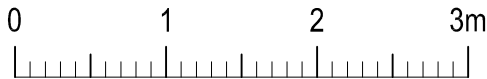

Tunnel Heading and Loading Machine

Model ITC 315N N1

Front, side and top view with boom geometry

Force acc. to ISO 6015, with standard bucket

Breakaway torque	85 kN
Tear-out force over Tilting cons.	53 kN
Tear-out force over dipper stick	62 kN
Lifting power (without working tool)	20 kN
Specific ground pressure	14,1 N/cm²
Global weight	37,2 t

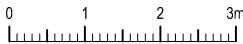

S950

16.04.2020 PB

I:\Acad\dessin_SITC315\

Dessin non contractuel

Rev.N°: Date:

1:100



CH-1920 MARTIGNY

Tf: +41 277 222 191

Fax: +41 277 222 185

info@itcsa.com